

MKD	SILL	LINTEL	SIZE	MKD	SILL	LINTEL	SIZE
DA	-	2400	1800X2400	W	350	2400	4000X2050
D	-	2400	1500X2400	W1	350	2400	2000X2050
DW	-	2400	3000X2400	W2	350	2400	1900X2050
DW1	-	2400	1800X2400	W3	350	2400	900X2050
DW2	-	2400	2825X2400	W4	1050	2400	1200X1350
D1	-	2400	1200X2400	W5	1500	2400	750X900
D2	-	2400	1100X2400	W6	1500	2400	750X900
D3	-	2400	900X2400	W7	1250	2150	600X900
D4	-	2400	750X2400	W8A	1050	2150	2000X1100
D2A	-	2150	1100X2150	W5A	650	2150	775X1500
D3A	-	2150	900X2150	W6	350	2400	1000X2050
D4A	-	2150	750X2150	W8	350	2400	1200X2050
FCD	-	2400	1100X2400	V1	2150	2150	600X600
FCD1	-	2150	1100X2150	SW & SW1	-	-	AS PER ELEVATION

SHEET NO. 3/7
SCHEDULE OF LAND :
 1. R.S. KHATAN NO. 151/1, 662, 156, 160, 152, 623, 624 & 626
 2. R.S. KHATAN NO. 66, 68, 69, 70, 71, 102, 112, 113
 3. R.S. PLOT NO. 471, 472, 483, 988, 478, 483 / 966, 483, 484
 4. R.S. PLOT NO. 45, 48, 49, 71
 5. SITUATED WITHIN MOUZA - DAGGRAM,
 6. SHEET N. - 3
 7. J.L. - NO.2
 8. WARD NO. - 41(SMC),
 9. PRGN. - BAIKUNTHAPUR
 10. P.S. - BHAKTINAGAR
 11. DIST. - JALPAIGURI
 12. HOLDING NO. - 158 / 3062, 159 / 3063, 157 / 3061, 156 / 3059, 3056, 92 / 1736
 13. APPROVED LUCC MEMO NO- 143/LUCC/APP/SIDA DT- 22.08.12 & 3730/SIDA DT- 22.10.19

CERTIFICATE OF ARCHITECT :
 I / We do hereby certify that plans, elevations and sections and other structural details of the proposed building on Plot No. mentioned above under the jurisdiction of Siliguri Municipal Corporation have been prepared in conformity with the relevant provisions under the West Bengal Municipal (Building) Rules, 2007. This is also to certify that all relevant "No Objection" Certificates from the respective Authorities such as Fire and Emergency Services Department, Airport Authority, Pollution Control Board, Telecommunication Department, etc as applicable in this regard, are also submitted with the application for seeking approval of the plan to construct/reconstruct/addition for alteration of the building on the said plot.

CERTIFICATE OF STRUCTURAL ENGINEER
 I / We do hereby certify that the foundation and superstructure of the building proposed for construction on Plot No. mentioned above, under the jurisdiction of Siliguri Municipal Corporation have been personally inspected and so designed by me / us will make such foundation and superstructure safe in all respect including the consideration of bearing capacity and settlement of soil and other conditions, if any, conforming to the stipulation of all relevant IS Codes of Practice and National Building Code.

(FOR SOIL ONLY)
 I / We do hereby certify that the foundation and superstructure of the building proposed for construction on Plot No. mentioned above, under the jurisdiction of Siliguri Municipal Corporation have been personally inspected and so designed by me / us will make such foundation and superstructure safe in all respect including the consideration of bearing capacity and settlement of soil and other conditions, if any, conforming to the stipulation of all relevant IS Codes of Practice and National Building Code.

DECLARATION OF STRUCTURAL REVIEWER :
 I / We do hereby certify that the building plan proposed for construction on Plot No. mentioned above under the jurisdiction of Siliguri Municipal Corporation have been visited by me / us and all the designs, drawings Nos. 1, 2, 3, 4, 5 Soil Test Report and Load Test Results for foundation and superstructure have been duly reviewed conforming to stipulations of all latest relevant IS Codes of Practice and National Building Code and it is found that every part is complete, in order and the proposed construction and its occupancy are safe in all respect.

DECLARATION OF OWNER :
 I do hereby declare that the building proposed for construction shall be supervised by the B.A.L.B.S. signing the building plan application or in his absence by any other B.A.L.B.S. of the appropriate category and as approved by the authority.

OWNERS DETAIL :
 Manushree Tea & India Pvt. Ltd. Represented by Director Harsh Baria
 Sri Sushil Kumar Baria
 Sri Manu Dey Baria
 Sri Harsh Baria
 Sri Deepak Baria
 Sri Gaurav Baria
 Wife of Sri Sushil Kumar Baria
 Son of Sri Sushil Kumar Baria
 Son of Sri Sushil Kumar Baria
 Son of Sri Sushil Kumar Baria
 Son of Sri Sushil Kumar Baria
 Son of Sri Sushil Kumar Baria

PROJECT :
PROPOSED PLAN OF (G + X) STORED RESIDENTIAL BUILDING AT MOUZA - DAGGRAM, J.L.NO. - 02, WARD NO.-41(S.M.C.), P.S.-BHAKTINAGAR, PRGN. -BAIKUNTHAPUR, 2ND MILE SEVOK RD, SILIGURI, DIST.-JALPAIGURI
TITLE :
OVERALL TYPICAL FLOOR PLAN (3RD TO 11TH FLOOR) & OVERALL ROOF PLAN
SCALE : 1:200
DRAWN BY : HAIMANTY
CHECKED BY : PAPIA
DATE : 29.09.2020
DRG. NO. : MAVA/285/SMC/03

MASS&VOID ARCHITECTS/INTERIORS
 4B, 4th floor, Dikta Hill Road,
 56, Chhatrapati Hotel, Parkside 700 046
 P-41 33 238 234
 C massvoid@gmail.com
 M www.massandvoid.com

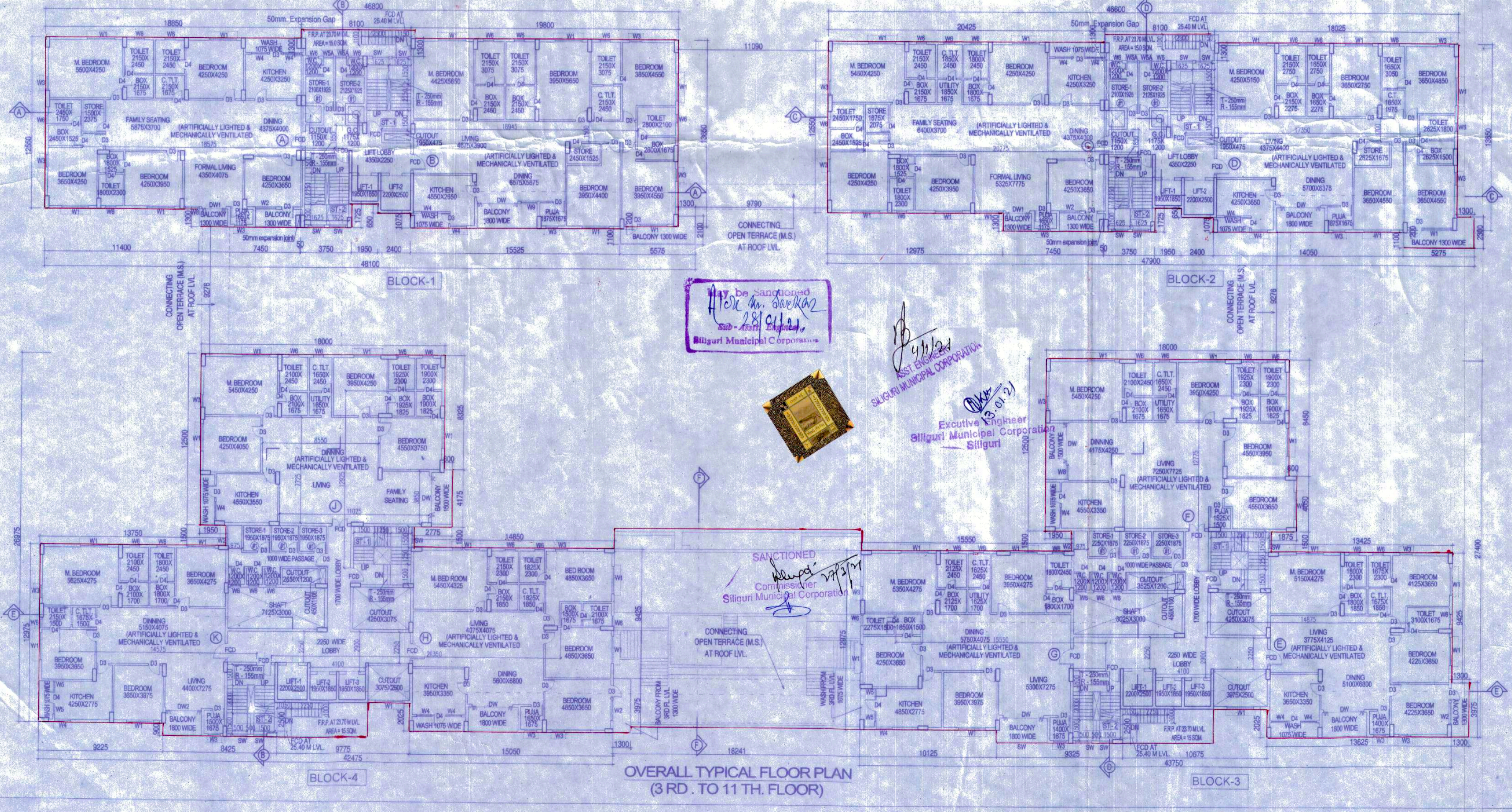
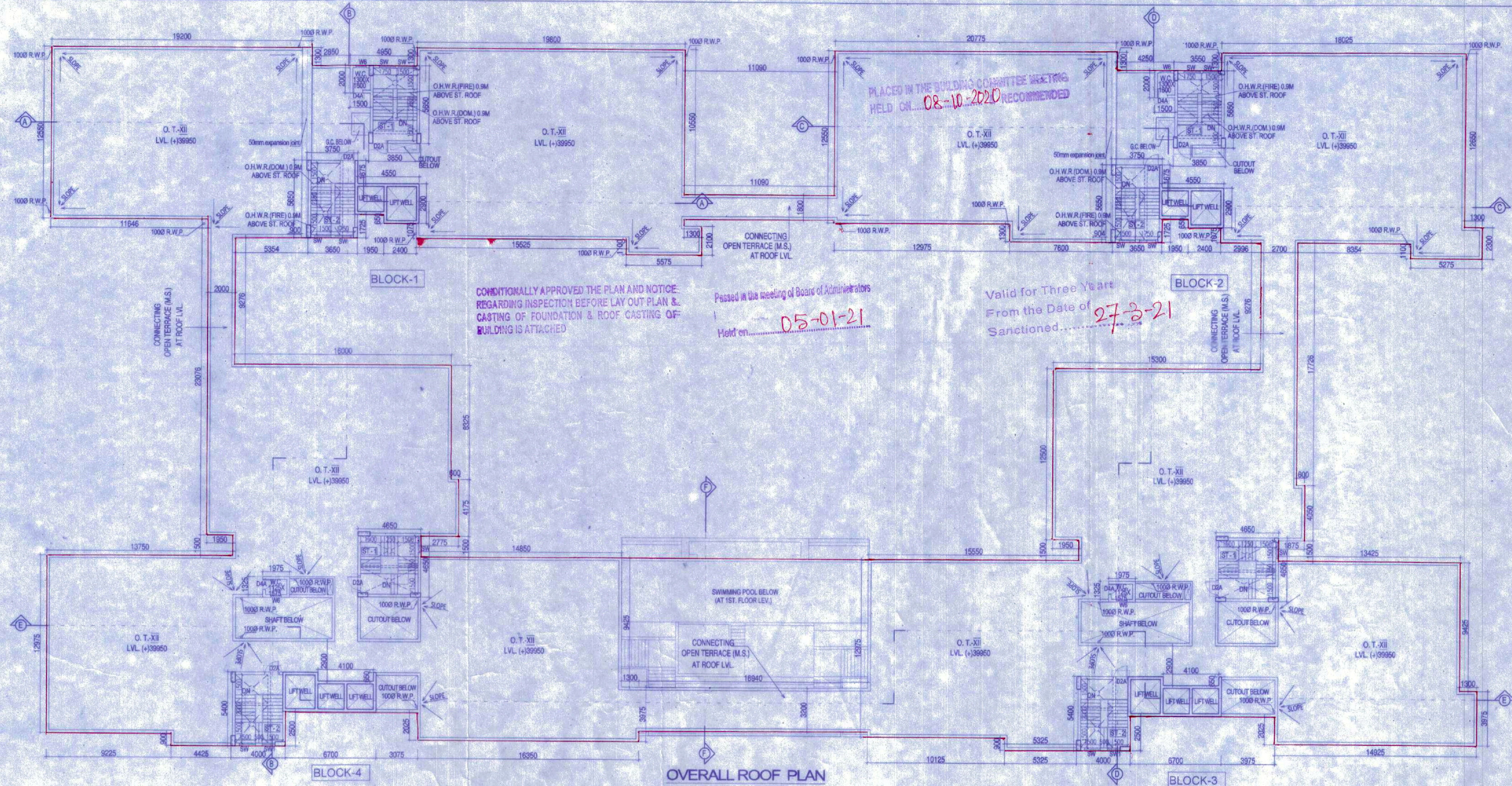

THIS PLAN IS CONDITIONALLY SANCTIONED THAT NO OBJECTION CERTIFICATE FROM FIRE SERVICE IS REQUIRED BEFORE OCCUPANCY CERTIFICATE

Approved by
 Siliguri Municipal Corporation

Executive Engineer
 Siliguri Municipal Corporation



MITUL SHUKLA (B.ARCH.)
 CA 2004/33251

SANJIV J. PAREKH
 M.E. (STRUCT.), M.E. (CONST. ENG.)
 B.C.E. (F-18292-A)
 E.S.E.-1-27 S.M.C.

SANJIB GUHA
 BSC, BCE, FIE (F-15654-5)
 CHARITRED ENGINEER
 REGISTERED STRUCTURAL REVIEWER 8816 K.M.C.

Director
 Manushree Tea & India Pvt. Ltd.

Signature of Owner